

TPP-2 / 2 Li

Two Post Parking Lift





Note: the image is for illustration purpose only.

> Introduction

TPP-2 & 2 Li are new members of two-post parking lift family. They are economic version of Hydro-Park 1127 & 1123, all major structural & safety features have been retained, specially developed for project use or massive installation. They provide simple and greatly cost-effective way to create 2 dependent parking spaces above each other. Operation can be easily done by turning a key switch.

Features

- Lifting capacity 2700kg or 2300kg.
- Car heights on ground up to 2050mm.
- Lifting height adjustable by limit switch
- Full-way anti-falling locks with lock-engage button
- Electric auto lock release enables easier operation.
- Photocell sensor detects car presence on ground
- 24v control voltage avoids electric shock
- Galvanized platform, high-heel friendly
- Driven by hydraulic cylinder + chain
- Synchronization chain keeps platform level under all conditions
- Powder coating provides long lasting surficial protection

General Parts



- ① Carriage
- ② Transparent oil tank (steel oil tank is optional)
- ③ Galvanized waving plate
- ④ Electric box
- ⑤ Key switch & emergency stop button
- ⑥ Dynamic anti-falling lock
- ⑦ Front footage
- ⑧ Limit switch
- ⑨ Power pack
- ⑩ Photocell sensor

Note: the image is for illustration purpose only.

> General

Model	TPP-2	TPP-2 Li
Vehicles parked per unit	2	2
Rated capacity	2700kg	2300kg
Available car length	5000mm	5000mm
Available car width	1850mm	1850mm
Available car height	2050mm	2050mm
Drive mode	Hydraulic cylinder + chains	Hydraulic cylinder + chains
Operation	Key switch	Key switch
Lifting speed	<50s	<50s
Descending speed	<35s	<35s
Power supply	100–480V, 1/3P, 50/60Hz	100–480V, 1/3P, 50/60Hz
Finishing	Powder coating	Powder coating

> Hydraulic

Model	TPP-2	TPP-2 Li
Pump motor power	2.2Kw	2.2Kw
Pump flow	2.6ML/r	2.6ML/r
Pump working pressure	16-17MPa	16-17MPa
Hydraulic cylinder	One-stage type	One-stage type
Hydraulic oil	L-HV 46#	L-HV 46#
Lifting chain	LH1266	LH1266
Balance chain	LH1066	LH1066

Safety devices

Limit switch in the top of the post. When the platform goes to the appointed height, it will automatic stopped to avoid the wrong operation

Pressure relief valve and pressure compensate flow control valve

Auto locking system in case electrical failure

Mechanical anti-falling safety lock every 100mm on the post

Photocell sensor available to check under car and avoid trespass

Synchronization chain

Overload protection device for hydraulic power pack

Electric protection for power over load or under voltage

Emergency stop button

Lock engage button, let platform rest on the safety locks

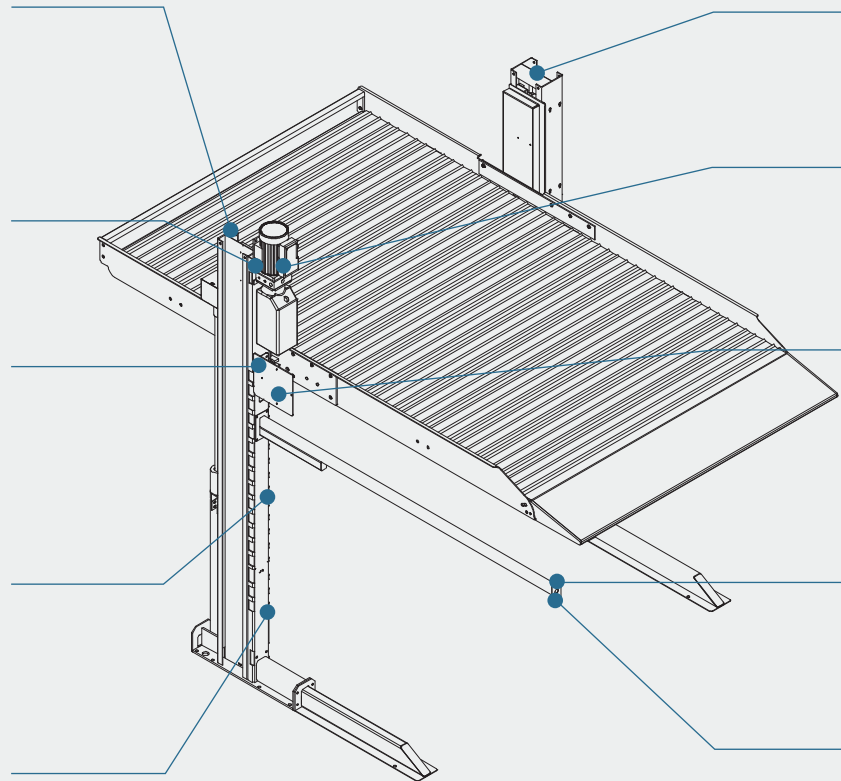

Dimensions

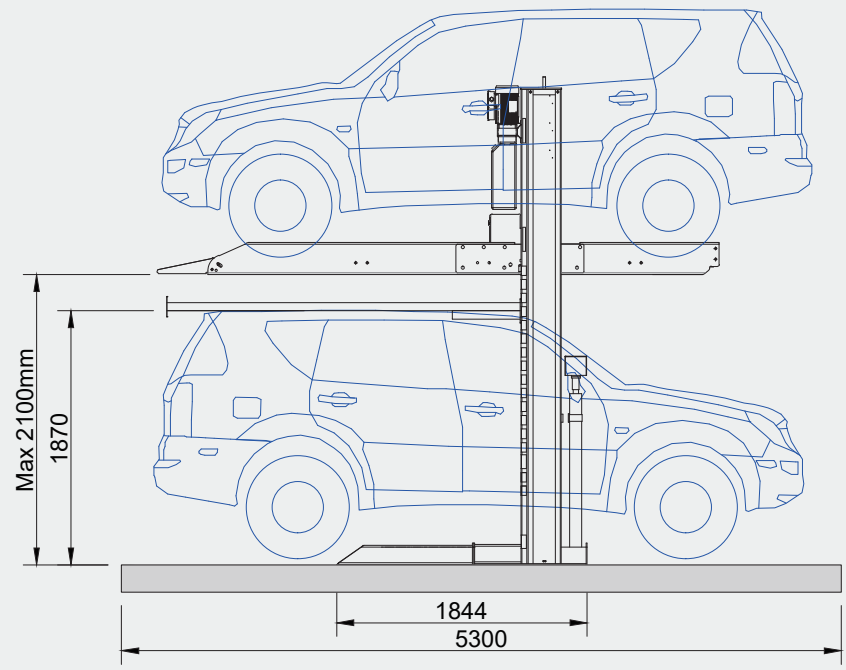
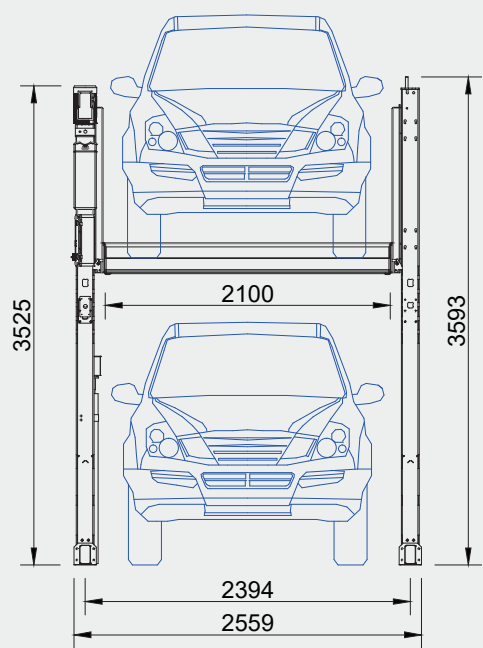

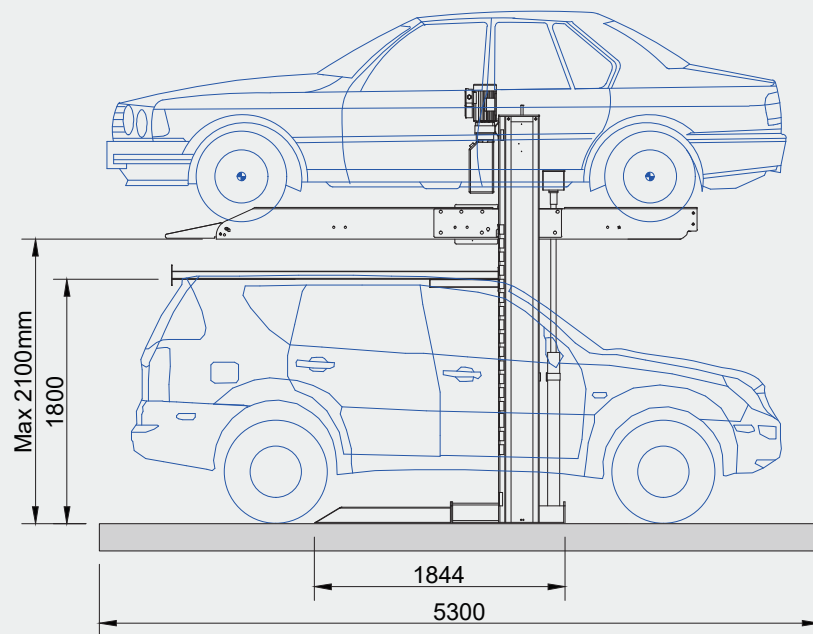
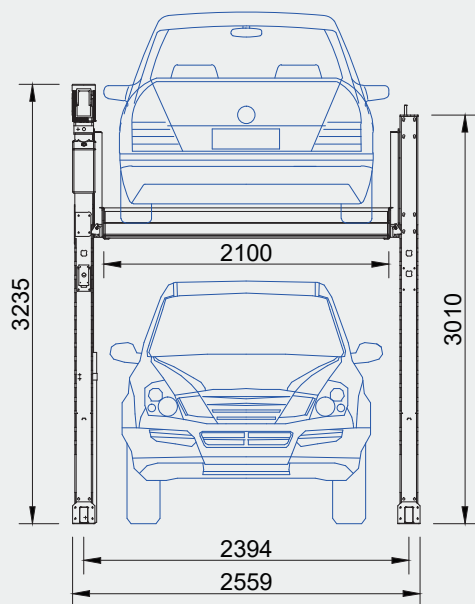

TPP-2 Li

Posts sharing feature

When the TPP-2 / 2 Li series products are installed side by side in a line, beside the first the unit, all the units installed after can share the posts in between. We call the first complete unit – Unit A, and all the rest of units – Unit B.

This unique design of sharing post feature is not only saving your critical spaces and cut costs, but also make the whole structure more stable and stronger by connect all units together.

> Width dimensions

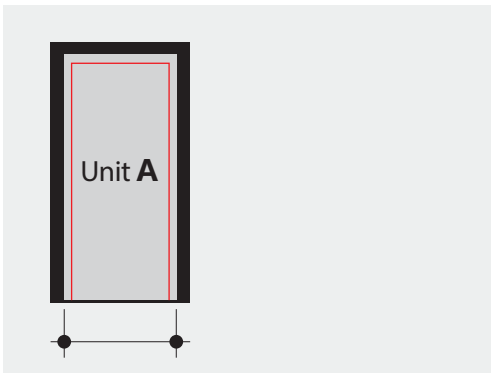

Total width
required

2559

Clear platform
width

2100

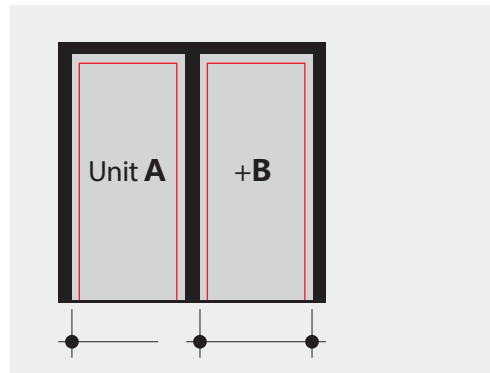

Total width
required

4953

Clear platform
width

2100

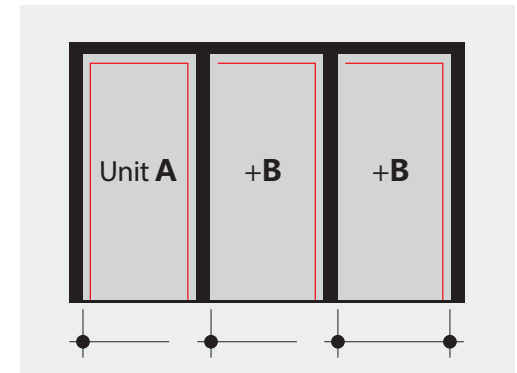

Total width
required

7347

Clear platform
width

2100

Note: when adding more Unit B in the line, every unit will require additional width of 2394mm (clear platform width 2100mm).

